



**ORLIMEX**  
*Composite systems*

# COMPOSITE SYSTEMS

**Composite materials for construction**

**THERMOSAVE®**

## Construction

The dowel consists of a plastic head with an impact-resistant rod made of composite material and plastic plug to provide a mechanical anchor. Extremely low thermal conductivity. Perfect for Passive House construction

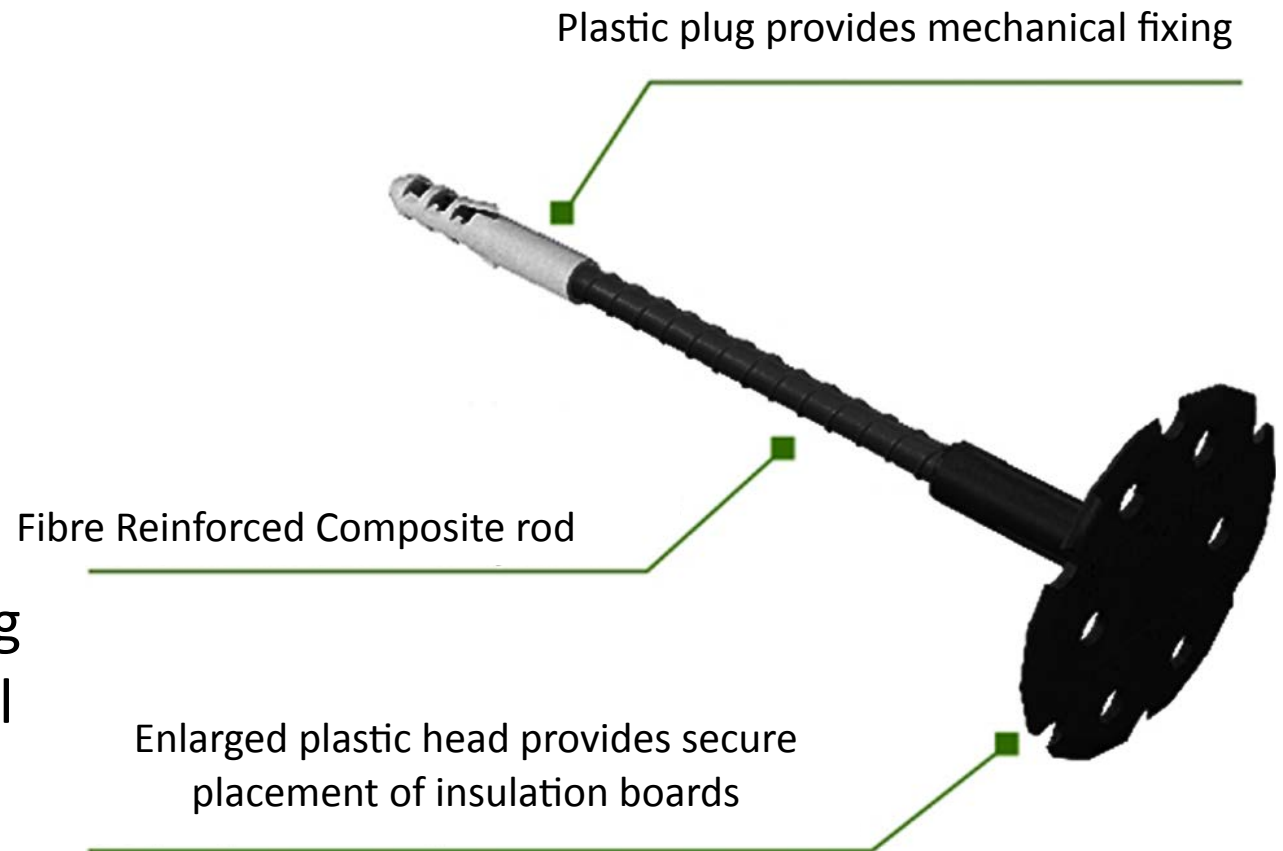





**Use**

THERMOSAVE® insulation dowels are used to attach insulation boards to the structural substrate of the building. Suitable for fixing to concrete, lightweight concrete aggregate blocks and masonry

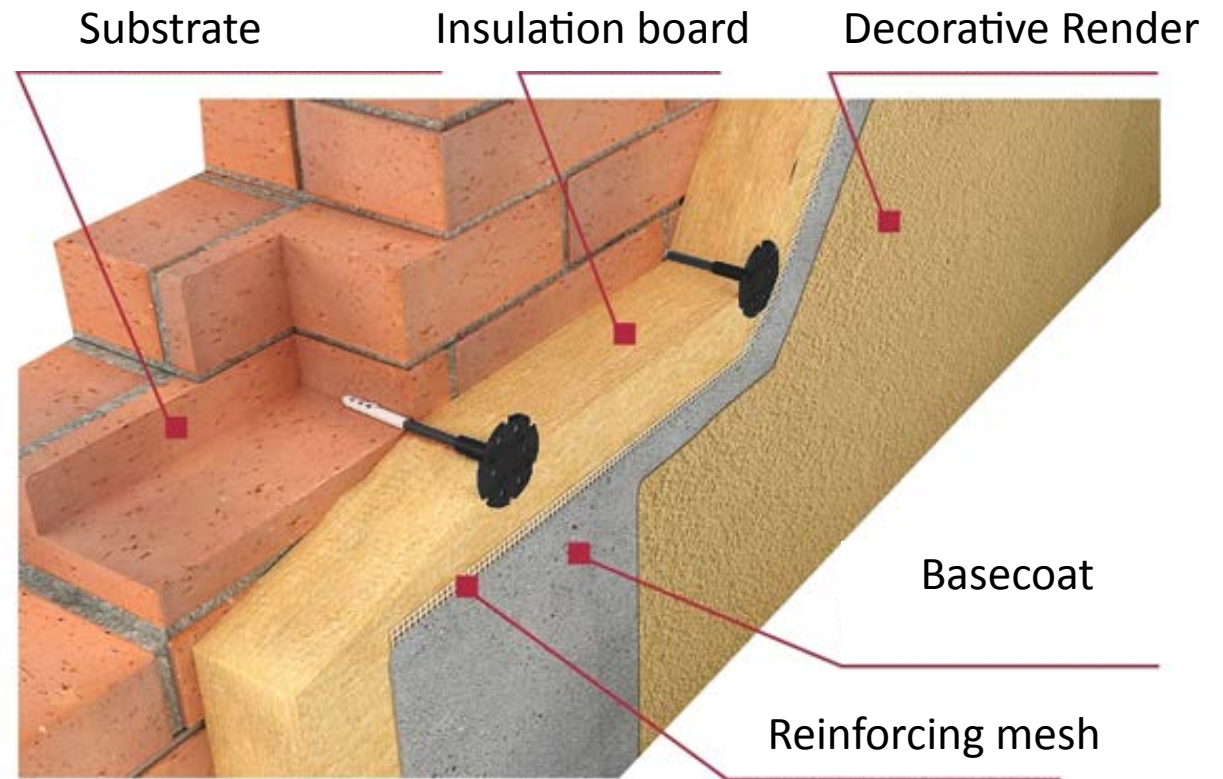



## Technical data

Length of dowel	From 100mm to 300mm
Shaft diameter	5 mm
Anchor depth	60 mm
Head diameter	60 mm
Tensile strength minimum	1000 MPa
Elastic strength minimum	1000 MPa

## Characteristic loads - minimum

A Concrete C25	0,16 κH
B Solid brick	0,14 κH
D Lightweight aggregate concrete	0,10 κH



**Certificate**

European Technical Assessment ETA 16/0134  
version 01 of 10/06/2016





## Benefits

1. The strength of composite materials improves the strength of the structure.
2. The low thermal conductivity of composite materials, prevents dowels from forming a thermal bridge between the wall of the building and the external environment, retains the original properties of the building structure
3. The frost resistance of the plastic dowel plate allows installation work to be carried out at low temperatures.
4. The rigidity and impact resistance of the dowel head reduces the likelihood of creating an "inverted umbrella" effect and destroying the external insulation system. Reduces the number of damaged dowels.
5. High bond strength in various building materials.
6. Corrosion and chemical resistance of the composite material eliminates the possibility of rust stains on the facade wall. The dowel retains its physical and mechanical properties.



## Use of composite dowels on the facade





**Contact**

Chris Hirst

National Manager

☎ +44(0) 7703 538785

✉ [chris@orlitech.co.uk](mailto:chris@orlitech.co.uk)

Alexander Bobryshev

Head of the composite materials department

☎ + 420 731 416 285

✉ [alexander.bobryshev@orlimex.com](mailto:alexander.bobryshev@orlimex.com)